

Installation instruction clevis hanger - SDC EG

Installation option 1:

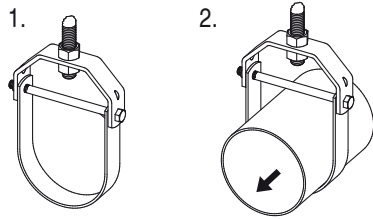

Assemble and install hanger on threaded rod as shown (rod and nuts not supplied)

Installation option 2:

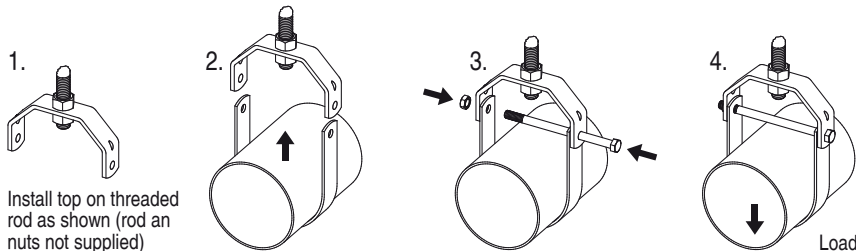

Install top on threaded rod as shown (rod and nuts not supplied)



nominal Pipe size	Rod size [RS]		Approval
1/2"	3/8"	M10	UL
3/4"			UL
1"			UL
1-1/4"			UL
1-1/2"			UL
2"			UL
2-1/2"	1/2"	M12	FM / UL
3"			FM / UL
4"	5/8"	M16	FM / UL
5"			FM / UL
6"	3/4"	M20	FM / UL
8"			FM / UL
10"	7/8"	M24	UL
12"			UL